

COLORADO CULTURAL RESOURCE SURVEY

Architectural Inventory Form

Official Eligibility Determination
(OAH P use only)

OAH P1403
Rev. 9/98

- Date _____ Initials _____
- Determined Eligible – National Register
- Determined Not Eligible – National Register
- Determined Eligible – State Register
- Determine Not Eligible – State Register
- Need Data
- Contributes to eligible National Register District
- Noncontributing to eligible National Register District



I. IDENTIFICATION

- 1. Resource number: **5BL.10138** Parcel number(s): **131503113001**
- 2. Temporary resource number: **N/A**
- 3. County: **Boulder**
- 4. City: **Longmont**
- 5. Historic Building Name: **Dye House; Johnson House**
- 6. Current Building Name: **Goon House**
- 7. Building Address: **741 Martin Street**
- 8. Owner Name: **Goon, Terri**
- Owner Organization:
- Owner Address: **741 Martin St
Longmont , CO 80501**

44. National Register eligibility field assessment:	Not Eligible
Local landmark eligibility field assessment:	Eligible

Architectural Inventory Form

Page 2 of 9

II. GEOGRAPHIC INFORMATION

9. P.M.: **6th** Township: **2N** Range: **69W**
NE ¼ of SE ¼ of NE ¼ of NE ¼ of Section 03
10. UTM reference
 Zone: **13** **492037 mE** **4446857 mN** **(NAD83)**
11. USGS quad name: **Longmont**
 Year: **1968 (photorevised 1979)** Map scale: **7.5**
12. Lot(s): **E 125 Ft Lot 7 Blk 21**
 Addition: **Longmont Original Town** Year of addition: **1872**
13. Boundary description and justification:
This legally defined parcel encompasses but does not exceed the land historically associated with this property.
 Metes and bounds?: Describe:

III. ARCHITECTURAL DESCRIPTION

14. Building plan (footprint, shape): **L-Shoed Plan**
15. Dimensions in feet: **Length: 30 feet x Width: 32 feet**
16. Number of stories: **1**
17. Primary external wall material(s): **Wood/Horizontal Siding**
18. Roof configuration: **Gabled Roof/Side Gabled Roof**
19. Primary external roof material: **Asphalt Roof/Composition Roof**
 Other roof materials:
20. Special features: **Porch**
Chimney
21. General architectural description:
This modest wood frame dwelling consists of the following building elements: the original (1905) side-gabled dwelling which measures 24' N-S (across) by 20' E-W (deep); a 16' N-S by 10' E-W shed-roofed addition to the south end of the west (rear) elevation, and an approximately 16' N-S by 10' E-W addition to the north end of the west elevation. Built in 1968, this last addition enlarged a historic 8' by 8' extension which had previously been built onto the north end of the home's east elevation. The house is supported by a low unpainted sandstone foundation, and its exterior walls are clad with painted blue horizontal wood siding, with 1" by 4" corner boards. The original side-gabled roof is steeply-pitched. This roof, and the roofs over the additions, are covered with asphalt composition shingles. The eaves are boxed with painted white wood trim. A red brick chimney is located on the roof ridge. The home's windows are primarily single 1/1 double-hung sash, with painted white wood frames and surrounds, and with exterior metal storm windows. A band of four 4-light (probably hopper) windows penetrate the shed-roofed addition at the west end of the south elevation, however. The house features a symmetrical façade on the east elevation. Here, a painted white with blue trim wood-paneled front door, with one upper sash light, and covered by a painted blue and white wood storm door, enters into the home. This door opens onto a 3-step concrete porch, with flanking black wrought iron railings, and covered by a shed roof with knee brace supports. Another painted blue and white wood-paneled door, with four upper sash lights, enters into the shed-roofed extension on the west elevation.

Architectural Inventory Form

Page 3 of 9

22. Architectural style: **Late 19th and Early 20th Century American Movements**

Building type:

23. Landscape or special setting features: **This house, with a detached garage, is located at the southwest corner of Martin Street and 8th Avenue, near the northeast end of Longmont's historic East Side residential neighborhood. The property features a small planted grass front yard, with a larger back yard and side yard to the north of the house. The rear yard is enclosed by a chain link fence. A gravel driveway extends from Martin Street, along the south side of the house, leading to a garage located a short distance southwest of the house.**

24. Associated buildings, features or objects:

1: Type: **Garage**

Describe: **A single-stall wood frame garage is located a short distance southwest of the house. This structure measures 10' N-S by 14' E-W, and is supported by a concrete foundation. It has painted white vertical wood plank exterior walls, and a very low-pitched gabled roof covered with rolled grey asphalt roofing material. A set of paired vertical wood plank garage doors, open onto a gravel driveway on the east elevation. The garage has a small shed-roofed extension on its west end.**

IV. ARCHITECTURAL HISTORY

25. Date of construction: Estimate: Actual: **1905**
 Source of information: **Town of Longmont Water Rent Collection Records; Longmont city directory, 1906.**

26. Architect: **Unknown**

Source of information: **N/A**

27. Builder: **Unknown**

Source of information: **N/A**

28. Original owner: **Sarah Stone**

Source of information: **Town of Longmont Water Rent Collection Records; Longmont city directory, 1906.**

29. Construction history:

Town of Longmont Water Rent Collection records reveal that the original portion of this house was built in 1905. As originally built, the small cottage had just two rooms and measured 24' N-S by 20' E-W. Some time prior to 1930, a small 8' by 8' addition was built onto the north end of the west (rear) elevation. At a later date (probably after 1956) a larger, 16' by 10' shed-roofed addition was built onto the south end of the east elevation. Finally, in August 1968, owner Clarence Johnson obtained a building permit to enlarge the earlier 8' by 8' addition, creating a small extension off of the rear northwest corner. Sanborn maps indicate that the garage predates 1930.

30. Original location: Moved: Date of move(s):

V. HISTORICAL ASSOCIATIONS

31. Original use(s): **Domestic/Single Dwelling**

32. Intermediate use(s): **Domestic/Single Dwelling**

33. Current use(s): **Domestic/Single Dwelling**

34. Site type(s): **Residence**

Architectural Inventory Form

Page 4 of 9

35. Historical background:

The earliest known occupant of this home at 741 Martin Street was Miss Sarah Stone. Miss Stone came to Longmont in 1902, from Wabash, Indiana, where she was born on October 13, 1856. She supported herself as a dressmaker, and was well-known for her work. Miss Stone lived at this Martin Street address through the early 1910s. By the early 1930s, she owned the property at 623 Terry Street. It was here, in her old age, that she suffered a fractured hip in a fall. She lived to be 91 years old, passing away on February 3, 1948. Following Sarah Stone, the Longmont City Directories indicate that the next resident of 741 Martin was R.C. Abbott. R.C. Abbott may well have been the son of George and Belle Abbott, who with children Clyde and Harvey, resided nearby at 720 Martin Street in 1910. George Abbott worked as a ranchman. In the late 1910s, R.C. Abbott had been replaced as the occupant of this home by Thomas H. Gephart. In 1910, Gephart had been living with his parents, Henry and Augusta Gephart in their home at 737 Martin. Thomas Gephart earned his living as a laborer. Five years later, this home was briefly the residence of H. L. Depue, followed in 1924 or 1925 by William A. "Will" and Ida E. Dye.

Will Dye was a Longmont native, born here on January 11, 1875. His parents, William E. and Olive Dye were members of the original Chicago Colorado colony, coming to Longmont in 1871. William Dye Sr. made the journey west hoping that Colorado's dry climate would help his ill health, which had suffered in a Confederate prison camp. Dye was born on March 29, 1834, at Rome, New York. When he was a lad of twenty, he moved to Chicago, where he married his wife, Olive Smith. The couple spent eighteen years in Chicago, where they raised four children, Luther, George, Ella, and Philo. Their fifth child, William A. Dye, was born after his parents moved to Longmont. Here, William Dye, Sr. carried the mail between Longmont and Estes Park. Using a team of horses hitched to a lumber wagon, the round trip took two days. When ill health forced him to relinquish this job, Dye supported his family as Longmont's general repair man. He passed away on January 31, 1883, when son Will was eight. To support her children following the death of their father, Olive Dye took in washing. According to the family's biography in *They Came to Stay*, the family faced some very difficult times, including one thanksgiving when the only food was cornmeal mush and molasses. As they grew, the sons were able to supplement their mother's income. Luther and Philo were express riders and horse handlers. Ella became the wife of Denver contractor Adna Smith. George worked at the Longmont Creamery and, once Will was old enough, trained him in the art of butter making.

In 1897, Will married Miss Ida E. Stevens. Ida Dye was born in King City, Missouri, on November 30, 1873, the daughter of Civil War veteran James Stevens and Martha Rosanna Day Stevens. When Ida was sixteen, her parents moved to Longmont with the three youngest of their nine children, daughters Anna, Ida, and Leonie. Once here, Ida completed her education, and was an 1893 graduate of Longmont High School. She then attended the Longmont Academy, and a year later received her teaching certificate. Before her marriage to Will Dye, Ida Stevens taught at the Noland, Little Thompson, Culver and Pella schools. Will supported his family at first through work at the Longmont Creamery. Once the sugar factory was built, however, Will went to work for the Great Western Company, where he operating the factory's main engine for many years. Tiring of this line of work, Will turned to farming in the Pleasant View Ridge District, southeast of Longmont. Upon retiring, Will and Olive Dye purchased this Martin Street home, where they spent the remained of their lives. Will Dye passed away in July 31, 1949, at the age of 74. Ida Dye lived to be 78. She passed away in September, 1952, having resided in Longmont for 62 years and at this Martin Street address for nearly thirty years.

Architectural Inventory Form

Page 5 of 9

Ida and Will Dye had one child, a daughter they named Lois. She was born on December 20, 1899, at Castle Rock, Colorado, where her father had been living temporarily while he set up a creamery. In February 1900, her parents returned to Longmont with their newborn baby. Lois was raised in Longmont, and it was here on March 16, 1920, that she married Clarence Elmer Johnson. The son of Lars Elmer Johnson and Mabel Beasley Johnson, Clarence was born on January 16, 1906 on a farm south of Longmont. His father's parents had come to the St. Vrain Valley in 1874, and his mother's family had settled here in 1882. Clarence and Lois attended Longmont High School together. Following their wedding, during the 1920s and 1930s, the couple farmed south of Longmont and on Colorado's eastern plains, where they raised their sons, William E. and James K. Johnson. The family then moved to Fort Collins, where Clarence was associated with Colorado State University. There, Lois was president of the Fort Collins Business and Professional Women's Club, and charter member of the Fort Collins Toastmistress Club, organizations she continued to be involved with upon the couple's return to Longmont.

Following Will's death, Ida Dye transferred ownership of this Martin Street home to her daughter and son-in-law, and following her death, Clarence and Lois took up residency in the home. Clarence worked for the Longmont Clinic; Lois also worked for many years at the Model Laundry in Longmont. Lois Dye Johnson passed away on June 21, 1988 at the age of 88. Her husband Clarence died a few months later, on April 11, 1989, ending more than 60 years of continuous ownership by the Dye and Johnson families. The record of the dwelling's occupants during the 1990s is sketchy, with the home frequently standing vacant or the tenants unrecorded. Building permit records show that in 1997, the owners were Deborah and Gilbert Lauron. By 2001, Terri A. Goon, had acquired the property. She remains the home's current owner and occupant.

36. Sources of information:

Sanborn Insurance maps.

Boulder County Assessor records.

"Lois Dye Johnson." [obituary]. Longmont Times-Call, June 22, 1988, p. 13-A.

"Resident Here 62 Years Dies Monday Night." [Ida E. Dye obituary] Longmont Times-Call, September 23, 1952, p.

1.

"Clarence E. Johnson." (obituary) Longmont Times-Call, April 13, 1989, p. 14-A.

(Boulder County) Real Estate Appraisal Card Urban Master. On file at the Boulder Carnegie Library.

Town of Longmont Water Rent Collection Records.

City of Longmont building permit files.

"Miss Sarah Stone Dies Today After 3-Year Illness." Longmont Times-Call, February 3, 1948, p. 1.

Longmont City Directories.

"Death Claims Will A. Dye." Longmont Times-Call, August 1, 1949, p. 1.

They Came to Stay: Longmont, Colorado 1858-1920. Longmont, Colorado: St. Vrain Valley Historical Association, 1971.

Architectural Inventory Form

Page 6 of 9

VI. SIGNIFICANCE

37. Local landmark designation: Yes No Date of designation:

Designating authority:

38. Applicable National Register criteria:

A. Associated with events that have made a significant contribution to the broad pattern of our history;

B. Associated with the lives of persons significant in our past;

C. Embodies the distinctive characteristics of a type, period, or method of construction, or represents the work of a master, or that possesses high artistic values, or represents a significant and distinguished entity whose components may lack individual distinction;

D. Has yielded, or may be likely to yield, information important in history or prehistory.

Qualifies under Criteria Considerations A through G (see Manual).

Does not meet any of the above National Register criteria.

Longmont Standards for Designation:

2.56.040-A (1) The structure or district has character, interest or value, as part of the development, heritage or cultural characteristics of the city, state or nation.

2.56.040-A (2) The structure or district is the site of a historic event with an effect upon society.

2.56.040-A (3) The structure or district is identified with a person or group of persons who had some influence on society.

2.56.040-A (4) The structure or district exemplifies the cultural, political, economic, social or historic heritage of the community.

2.56.040-B (1) The structure or district portrays the environment of a group of people in an era of history characterized by a distinctive architectural style.

2.56.040-B (2) The structure or district embodies those distinguishing characteristics of an architectural type specimen.

2.56.040-B (3) The structure or district is the work of an architect or master builder whose individual work has influenced the development of Longmont.

2.56.040-C (1) The structure or district, because of being part of or related to a square, park or other distinctive area, should be developed or preserved according to a plan based on a historic, cultural or architectural motif.

2.56.040-C (2) The structure or district, due to its unique location or singular physical characteristics, represents an established and familiar visual feature of a neighborhood, community or the city.

39. Area(s) of significance: **Not Applicable**

40. Period of significance: **Not Applicable**

41. Level of significance: National: State: Local:

Architectural Inventory Form

Page 7 of 9

42. Statement of significance:

This house is historically significant for its association with Longmont's residential development during the early 1900s. Built in 1905, it is representative of East Side neighborhood houses, built as part of a housing boom which followed the opening of Longmont's Great Western Sugar Company in 1903. The house is also architecturally significant for its representative side-gabled plan. The property's level of significance is not to the extent that it would qualify for individual listing in the National Register of Historic Places, or in the State Register of Historic Properties. The property, though, does likely qualify for individual local landmark designation by the City of Longmont. It would also be considered a contributing resource within a National Register designated, or locally designated, historic district.

43. Assessment of historic physical integrity related to significance:

This property exhibits a reasonably high level of integrity, relative to the seven aspects of integrity as defined by the National Park Service and the Colorado Historical Society - location, setting, design, materials, workmanship, feeling and association. Modest additions have been built onto the original dwelling, most recently, apparently, in 1968. These additions, however, are relatively small in scale, and are compatible with the house's original construction. Overall, a sense of time and place of a modest, early twentieth century, wood frame dwelling is still in evidence.

VII. NATIONAL REGISTER ELIGIBILITY ASSESSMENT

44. National Register eligibility field assessment: **Not Eligible**

Local landmark eligibility field assessment: **Eligible**

45. Is there National Register district potential? Yes No

Discuss: **This property is located outside the boundaries of Longmont's existing Eastside Historic District.**

There is potential that the district's boundaries could be extended east to Martin Street to include this block. This property would qualify as a contributing resource if it were located within the district's boundaries.

If there is National Register district potential, is this building: Contributing Noncontributing N/A:

46. If the building is in existing National Register district, is it: Contributing Noncontributing N/A:

VIII. RECORDING INFORMATION

47. Photograph number(s): **CLG Grant #08-05-20407-027 -** Negatives filed at: **City of Longmont**
CD-3, Images 177-181

48. Report title: **Eastside and Westside Neighborhoods: Historic** Department of Community
Context and Survey Report Development, Planning
Division

49. Date(s): **04/30/06** Civic Center Complex

50. Recorder(s): **Carl McWilliams** 350 Kimbark Street

Longmont, Colorado 80501

51. Organization: **Cultural Resource Historians**

52. Address: **1607 Dogwood Court**
Fort Collins, Colorado 80525

53. Phone number(s): **9704935270**

Architectural Inventory Form

Sketch Map

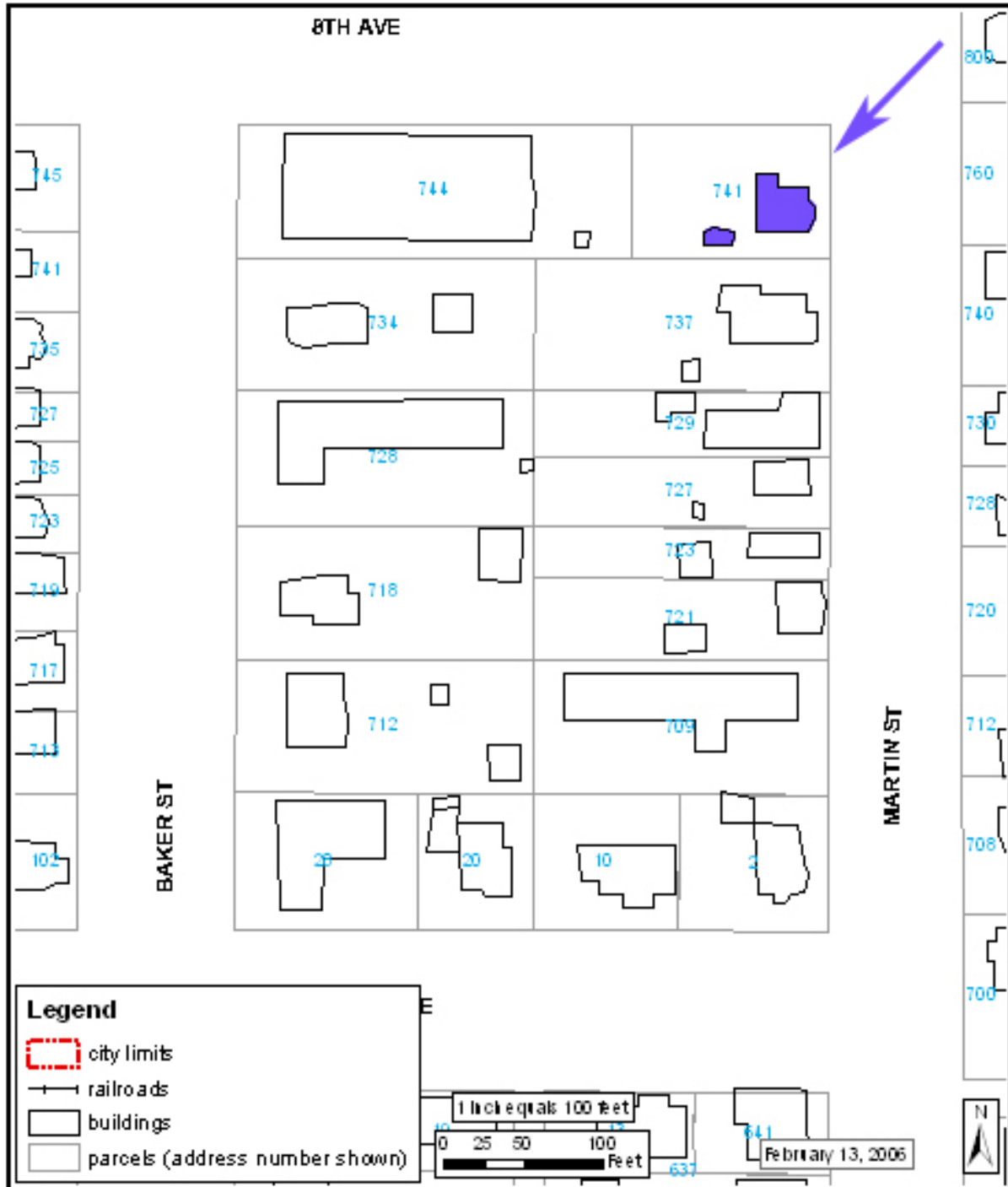

Architectural Inventory Form

Location Map

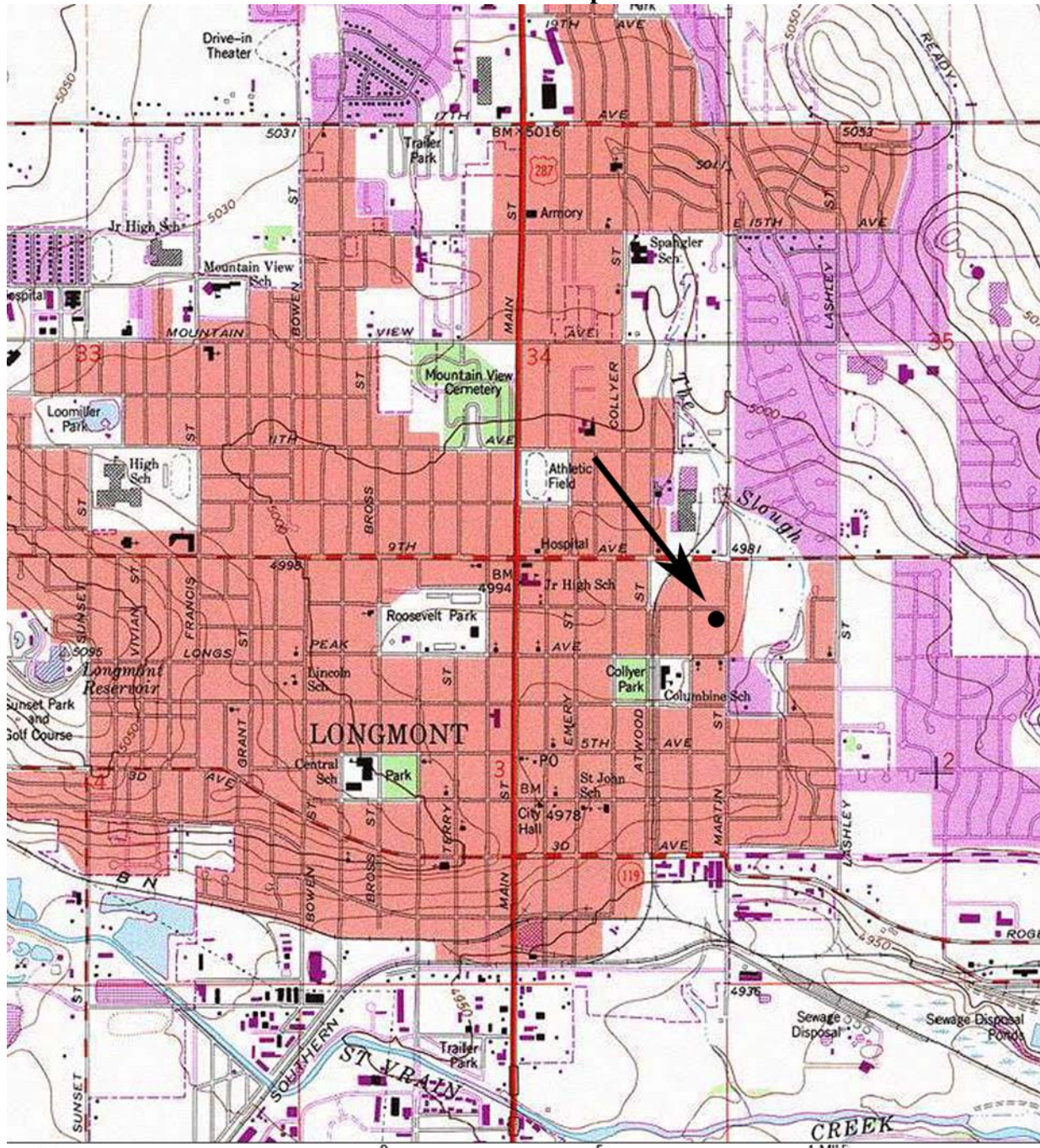

TN
MN
10°



Map created with TOPO!® ©2003 National Geographic (www.nationalgeographic.com/topo)